

**MODEL No:** SC3300

**Description:** 3300 mAh SIZE NI-MH SC

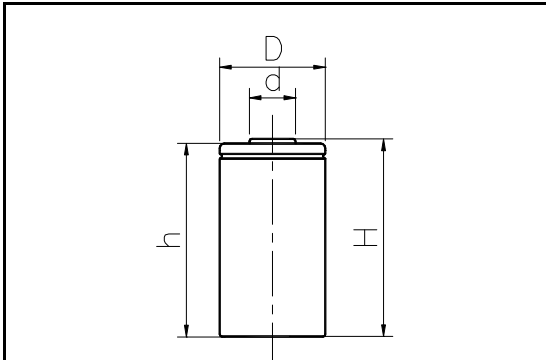

Dimensions(without Tube) (mm)

D	22.00±0.10
d	10.00±0.08
H	42.00±0.50
h	41.50±0.50

**Specification**

Nominal Capacity		3300 mAh
Nominal Voltage		1.2 V
Charge current	Standard	330 mA
	Fast	990 mA
Charge time	Standard	16 Hrs
	Fast	4 Hrs
Ambient Temperature	Charge	Standard 0°C~45°C
		Fast 10°C~45°C
	Discharge	-20°C~60°C
Storage		-20°C~55°C
Internal Impedance(mΩ) (After Charge)		≤ 13
Weight		56.0 g

