

MODEL No: J-4/5SC2000

Description: 2000 mAh SIZE NI-MH SC

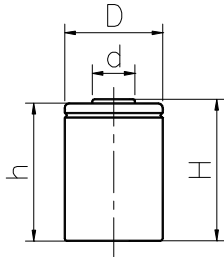

Dimensions(without Tube) (mm)

D	22.00±0.10
d	10.00±0.08
H	32.50±0.50
h	32.00±0.50

Specification

Nominal Capacity		2000 mAh
Nominal Voltage		1.2 V
Charge current	Standard	200 mA
	Fast	1000 mA
Charge time	Standard	16 Hrs
	Fast	2.4 Hrs
Ambient Temperature	Charge	Standard Fast
	Discharge	0°C~45°C 10°C~45°C
	Storage	-20°C~60°C -20°C~55°C
Internal Impedance(mΩ) (After Charge)		≤ 16
Weight		43.0 g

