

MODEL No: 7/5A2000

Description: 2000 mAh SIZE NI-Cd A

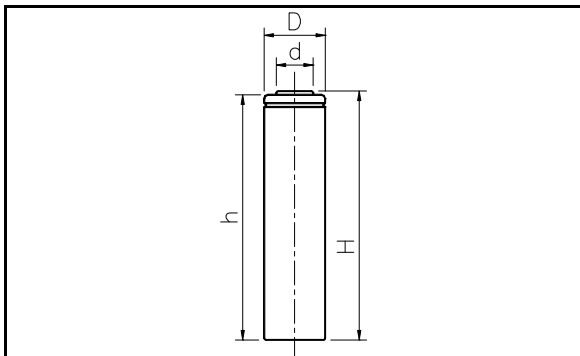

Dimensions(without Tube) (mm)

D	16.60±0.10
d	7.00±0.08
H	66.20±0.50
h	65.80±0.50

Specification

Nominal Capacity		2000 mAh	
Nominal Voltage		1.2 V	
Charge current	Standard	200 mA	
	Fast	1000 mA	
Charge time	Standard	16 Hrs	
	Fast	2.4 Hrs	
Ambient Temperature	Charge	Standard	0°C~45°C
		Fast	10°C~45°C
	Discharge		-30°C~60°C
	Storage		-20°C~60°C
Internal Impedance(mΩ) (After Charge)		≤ 20	
Weight		41 g	

