

MODEL No: 5/4SC2400

Description: 2400 mAh SIZE NI-Cd SC

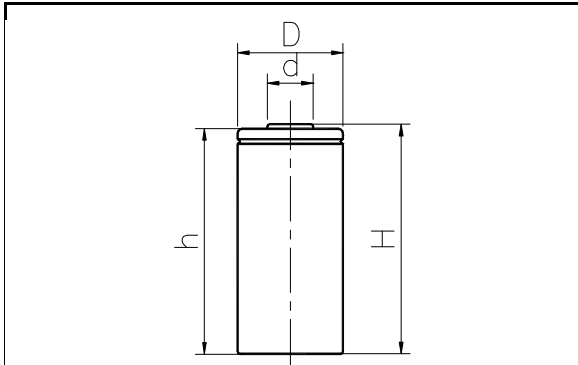

Dimensions(without Tube) (mm)

D	22.00 ± 0.10
d	10.00 ± 0.08
H	49.00 ± 0.50
h	48.00 ± 0.50

Specification

Nominal Capacity		2400 mAh	
Nominal Voltage		1.2 V	
Charge current	Standard	240 mA	
	Fast	1200 mA	
Charge time	Standard	16 Hrs	
	Fast	2.4 Hrs	
Ambient Temperature	Charge	Standard	0°C~45°C
		Fast	10°C~45°C
	Discharge		-30°C~60°C
Storage		-20°C~60°C	
Internal Impedance(mΩ) (After Charge)		≤ 12	
Weight		54 g	

