

**MODEL No:** 2/3AAA170

**Description:** 170 mAh SIZE NI-Cd AAA

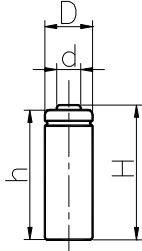

Dimensions(without Tube) (mm)

D	10.00±0.10
d	5.10±0.08
H	27.50±0.50
h	27.00±0.50

**Specification**

Nominal Capacity		170 mAh	
Nominal Voltage		1.2 V	
Charge current	Standard	17 mA	
	Fast	170 mA	
Charge time	Standard	16 Hrs	
	Fast	1.2 Hrs	
Ambient Temperature	Charge	Standard	0°C~45°C
		Fast	10°C~45°C
	Discharge		-30°C~60°C
Storage		-20°C~60°C	
Internal Impedance(mΩ) (After Charge)		≤ 72	
Weight		5.6 g	

